

Nintendo®

GAME BOY®

SUPERMARKET

 **SPREE DX**

INSTRUCTION MANUAL

pacdude games

Warning: Please carefully read the consumer information and precautions booklet included with this product before using your Nintendo® Hardware System, Game Pak™ or accessory. This booklet contains important safety information.

Cautions During Use

- Take a 10 to 15 minute break every hour or so when playing for long periods.
- Handle your Game Boy™ and Game Pak™ with care and avoid extreme temperatures, rough handling, or disassembly.
- Avoid touching or exposing the terminals to water to prevent malfunction.
- Use non-volatile solvents when cleaning this equipment, avoiding substances like thinner, benzene, or alcohol.
- Store the Game Pak™ in its protective case when not in use.
- Certain individuals may experience seizures from flashing lights or patterns commonly found in daily life. This can occur while watching TV or playing specific video games. If you have epilepsy or exhibit symptoms such as altered vision, muscle twitching, or convulsions while playing, consult a physician.

Game Boy™ and Game Pak™ are trademarks of Nintendo of America. Pacdude Games in no way represents the companies, corporations or brands mentioned in this game. The brands are used fictitiously; Pacdude Games does not speak for or represent these brands. Game design, mechanics, art, music and SFX are © 2023 Pacdude Games.

Introduction

Start your engines! What kind of race is this? It's all done with shopping carts! You race through a supermarket and things go flying into your cart! It's wonderful—wild—amazing! Let's face it—you never know what's going to happen on Supermarket Spree! Who's got the Game Boy™ Game Pak™? OK, you're on!

It's time to play Supermarket Spree!

Starting The Game

- Ensure the power switch is OFF.
- Insert the Supermarket Spree DX cartridge (label side out) into the Game Pak slot at the rear of the Game Boy™. (Consult your Nintendo® Game Boy™ instruction booklet for help.)
- Turn the power switch ON.
- Press Start on the title screen to access the Main Menu.

Game Controls

+ Control Pad

Moves your shopper around the supermarket, chooses menu items, and directs your hand when browsing aisles.

A Button

Enters aisles, activates options, advances through dialogue, picks up or puts items down, and drops items into your cart. Empties your cart when at the Checkout Line.

B Button

Exit an aisle when pressed. Cancels bread selection.

Start Button

Advances Title Screen, pauses game. (Game cannot be paused while a dialogue box is on screen.)

Select Button

In Free Shop Mode, exits to Title Screen. During the Big Spree, recalls the Host's Grocery List.

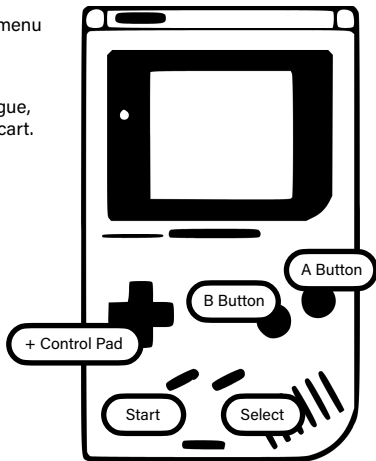

The Main Menu

There are three modes in the game, and you can start any of them from the main menu.

Select a Game Mode

Use Up and Down on the + Control Pad to move the on-screen shopper next to one of the following game modes. Use the A or Start button to choose one of the modes:

TV Show Mode

You'll experience all the fun of Supermarket Spree in the palm of your hands. Solve tricky grocery puzzles, take on the Mini Spree, and complete our Round Robin challenges in order to build up time for the Big Spree! Complete all the goals in the Big Spree and you'll move on to our Bonus Spree for an additional Bonus Jackpot of \$5,000!

Time Attack Mode

In this mode, you're given a flat 2 minutes to run wild through the aisles trying to rack up the highest score possible.

Free Shop Mode

Take a cart, walk around, and enjoy browsing through the supermarket. No goals, no timer, just vibing in our aisles!

The Supermarket

Our Supermarket Spree supermarket is packed to the brim with everything you'd expect from a modern supermarket, including a full-service deli, soda fountain, and more.

The lowest part of Aisle 1 is the Checkout Line. That's where you start every Spree in our Market, and where you'll empty your cart during your Sprees.

The Big Spree

In TV Show and Time Attack Mode, you'll be taking on The Big Spree. In the Big Spree, you'll have a certain amount of time spent shopping and frantically trying to get as many groceries as you can into your shopping cart and emptied at the Starting Line. You may also find yourself having to complete certain challenges:

Grocery List: During every Spree, the host will give you a grocery list of 3 items to grab. You have to find all three items, add them to your cart, and cash them in at the Checkout Line before time runs out in order to complete the Spree. **If you don't get all the items before time runs out, you'll end with no score.**

Deli: The host might be hungry! He will give you his order, and you have to order it before time expires to bank the bonus. If you screw up, you can return to the deli and throw the sandwich away, and then make a new one whenever you'd like, as long as you have time on the clock. Complete the correct sandwich and earn \$250!

Deli

Potato Chips

Int'l Bread Center

Bakery

Diet Colas, Teas & Water

AISLE
14

Baby Care

Health & Personal Care

AISLE
13

Bath & Beauty

Cereal & Breakfast

AISLE
12

Cookies & Lunch Snacks

Pet Food & Care

AISLE
11

Condiments, Oils & Vinegars

Bathroom & Home Cleaners

AISLE
10

Laundry Care

Housewares

AISLE
9

Ice Cream

Frozen Entrees

AISLE
8

Candy

Soda, Seltzers and Teas

AISLE
7

Soups, Broth & Chili

Rice, Pasta & Sauce

AISLE
6

Global Flavors & Canned Meat

Spices, Sauces & Pickles

AISLE
5

Whole Nuts, Spreads & Snacks

Sausages, Storage, Sandwiches

AISLE
4

Toilet Paper, Paper Towels & Trash Bags

Scented

AISLE
3

Canned Vegetables

Coffee, Tea & Crackers

AISLE
2

Ice Cream Novelties

Fries & Snacks

AISLE
1

Meat & Dairy

Fresh Vegetables

Frozen Pizza

Frozen Vegetables

Coffee Grinder: If the Coffee Grinder is working, repeatedly mash the A button to fill up your coffee bag with beans! If you fill it up successfully, you'll bank the bonus. If you add too few beans before time runs out, you won't get your bonus. If you fill the bag too much, you'll have to start over! Fill up your bag and earn \$250!

International Bread Center: In our International Bread Center, there's baskets of different breads, bagels, baked goods and bialys just waiting to be wrapped up! Before the Spree, the host will read you a list of the three types of baked goods to grab. Select the correct breads; if you get exactly what's asked, you'll earn \$250!

Inflatables: Throughout the supermarket, oversized inflatable food and drink items may appear! If you grab one of them, it'll fill up all your available cart space! Bring the inflatable to the Checkout Line before time runs out and you'll get a bonus of either \$200, \$250, \$300 or you might even get the \$500 Super Bonus!

 **Beta Build Disclaimer**

The following Bonus mini-games are not active in the game yet.

Mystery Product: Some aisle endcaps may have monitors on them. Activating the Monitor will give a one-word clue that relates to one of the products in our supermarket. There are 3 monitors all together, so if you can find all three, you'll have a great idea what

the mystery product is. Add the Mystery Product to your cart and empty it out any time during your Spree to bank a \$100 bonus!

Soda Fountain: Our host might get thirsty! If the Soda Fountain is working, fill up the requested cup with the correct soda by hovering over the proper fountain nozzle and mashing the A button. If you fill it up successfully, you'll bank the bonus. If you add too little soda before time runs out, you won't get your bonus. If you fill the soda cup too much, you'll have to start over! Fill up the cup and earn \$250!

TV Show Mode

In TV Show Mode, you'll play a full game of Supermarket Spree. TV Show Mode is divided into three rounds: The Question Round, The Big Spree, and the Bonus Spree. In TV Show Mode, you start with a bank of 1 minute 30 seconds of Big Spree time. You'll use the Question Round to earn extra time and Big Spree bonuses, and if you can beat the Big Spree, you'll play the Bonus Spree for the grand prize!

The Question Round

In the Question Round, you'll answer grocery-based trivia games and compete in supermarket challenges in order to bank time in the Big Spree. The first challenge is always the Mini Spree, followed by two trivia games, and then the Round Robin.

The Mini Spree: In the Mini Spree, the host will read you a clue that will lead you to an item in the Supermarket. You'll have 30 seconds to find the product, put it in your cart, bring it back to the Starting Area and unload your cart. If you can bring back the product within 30 seconds, you'll get :10 added to your Big Spree Time total. If you can bring back the product within 20 seconds, you'll get :30 added to your Big Spree Time.

Trivia Games: From here, you'll be given several different trivia challenges. Some may challenge your knowledge of grocery brands, or facts about grocery items, or even things like their prices. Correct answers bank :10 toward your Big Spree Time total.

Round Robin: The Round Robin will be the last chance to add precious time to your Big Spree Time total. During the Round Robin, you'll be shown three items, and then given a clue. Select the item you think best fits the clue. If you're right, you'll get :10 added to your Big Spree Time.

After you get through all the games in the Question Round, you'll take whatever time you earned and use it in The Big Spree!

The Big Spree

See the main Big Spree section in the instructions for more detailed instructions on how to play. The Big Spree is where you convert the time you banked in the Question Round into big money! Race up and down the aisles, find the products you want or need, put them into your cart, and unload them at the Starting Line, and bank up the highest total

you can! Before the Big Spree starts, the host will tell you how much time you have to run your Big Spree. He will then list out the bonus opportunities you can choose to partake in, and then you'll be given a dollar amount you'll have to hit as your goal amount. If you score more than that goal, you'll move on to the Bonus Spree! **You must still grab all 3 Grocery List items in order to Complete the Sweep.**

The Bonus Spree

The Bonus Spree is a 60-second turbo scavenger hunt to find three items in our store. The host will read a clue, and you'll have to find the item the clue relates to and bring it back to the starting line. If you're correct, you'll get the next clue. If you're not, the host will tell you to find another item. If you can get three items correct, you'll earn a \$5,000 Grand Prize bonus and your final total will be displayed!

Online Leaderboards

Show off your incredible high scores on our online leaderboard! After each game in either TV Show Mode or Time Attack mode, you'll be given the option to get a 7-letter code to enter on our website, at <https://ssdx.online>. You'll enter your code, initials and email address and you'll be added to our high score leaderboards!

Credits

Cory Anotado

Executive Producer

Christian Carrion

Producer, Puzzle Writer

MelonadeM

Music

Coffeebat

Sound Effects

Designed in GB Studio 3

Special Thanks to our Patreon Supporters:

Elizabeth Rice • Curtis Gray • Andrew Long • Sheldon W. Lewis II • Andrew L. Budny • Dave Mattingly • gx3s22owdrkpjwh5hafp • Jeffrey Miller • Gate Keeper • Josh Halbur • Michael Doyle • Kyle Hirshon • Patrick Patterson • William I. Wells • Matthew DiGirolamo • Dave Hurd • Jsach • TheGoodDoctor • Drew Summers • Nicholas Todor • Michael Sell • TroyTakesPhotos • Chad Estes • Andres Pino • Game Show Blitz • Benjamin Williams • Cory Lawrence • Christian Carrion • Justin Rhea • Colin Darnell • Chris • Kristen McKenzie • Chris Michaud • Neil Morse • Jeff Peck • Eric Taylor • Stad St. Fleur • Jeff Metzner • C.A. Riley • Doug Roberts • Matthew Cox • Frank Driscoll • Andy Saunders • Franco Carcelli • Cozene Watson • Joey Palumbo • Maurice Schneider • Richie B • Megan Gillespie • Denver Murray • Brian Moss • Emilee • Susan Lam • Julius Mitchell • K.C. So • Matthew Smith • Oskar B • Brandon Segebart • Brian Barrish • Kevin Richman • wvu1989 • Daniel Blake • Heather Hurley • Dreaded Blonde • Oliver Langland • Robert McKee • Andrew Truong • Colby John • Nick • Elizabeth Boerschig • David Roman • Richard • Alec Roth • rangerdj1 DJ • Gianni Pizzi • James Osborne • Abs M Rice • Joe Taylor Jr. • Ian McGecko • dj ting • Ron • Kris Waterman



Visit us on the web: PacdudeGames.com

